

**EXPERTS-CHOICE™
DECAL**

BARE-METAL FOIL CO. • P.O. BOX 82 • FARMINGTON, MI 48332

Item No. 122

INK JET

CLEAR DECAL FILM THREE SHEET PACK

Experts-Choice Decal Film is available in both clear and white one and three sheet packs. With Experts-Choice plain decal film you can use your own color ink jet or laser printer to make home made decals. You can also use a color photo copier to reproduce any decal of your choice. This material allows you to use existing artwork from books, magazines, computer clip art, or your own original art to create any decal. The standard 8 1/2 x 11 sheets work perfectly with any copier or printer.

QUICKLY AND EASILY CREATE YOUR OWN CUSTOM DECALS.

1



First select the image or images you want to scan or create your own graphics in your drawing and printing program. *Before you print the images onto the decal paper you may want to make sure that everything fits by printing a sample on plain white paper.* If everything fits, proceed with printing your art work on the Experts-Choice Decal Paper.

After printing, we recommend coating the decal with a fine spray of Microscale Liquid Decal Film (our stock #127). Let this dry and then give it another heavier coat and let it dry thoroughly. If you do not have an airbrush you can use a wide, soft brush.

2

This will do two things. It will protect the image from smudging while handling. It will also strengthen the film so it will not bunch up when applying it to your object.

You are now ready to apply your decal as you would any other water slide decal.



3

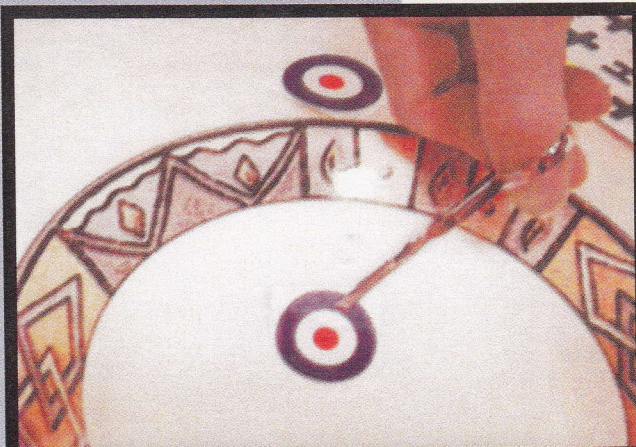

Cut out the image you wish to apply and place it in a bowl of luke warm water. As soon as it moves easily on the backing paper, remove it from the water.

Special rates apply for bulk purchases. Call Bare-Metal for prices.

4



Slightly moisten the area where you are going to apply the decal with Microscale Micro Set (our stock #128). This will prepare the surface with special wetting agents. Slide the image onto the surface.

5

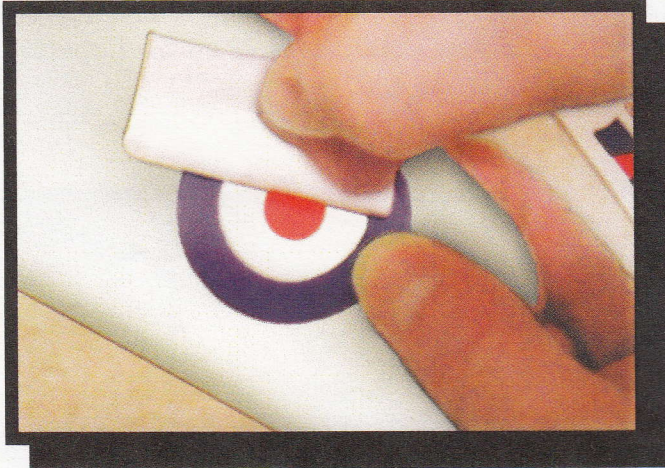

Use a soft damp cloth to blot away excess liquid and smooth the decal in place.

6

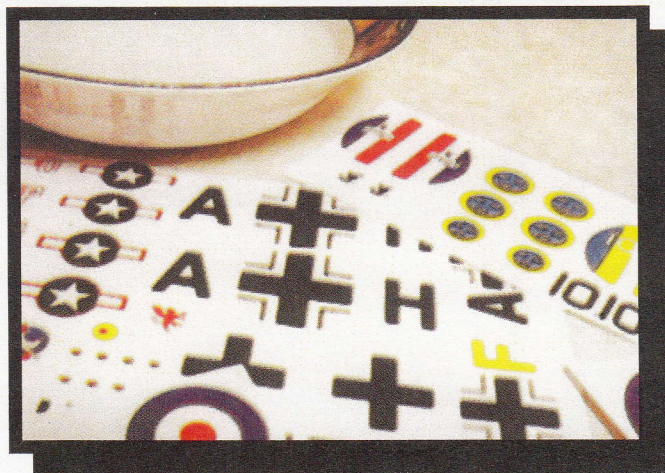

Using a soft brush, apply a light coat of Microscale Micro Sol (our stock #129). This will soften the decal and allow it to become part of the surface. **DO NOT TOUCH** it after applying the Micro Sol. Just allow it to dry.

BARE-METAL FOIL CO.

PRODUCTS FOR THE FASTIDIOUS MODELER
P.O. BOX 82 • FARMINGTON, MI 48332

(248) 477-0813 Days • (248) 476-3343 Fax • (248) 476-4366 Evenings or Messages
E-Mail • baremetal@mediagone.net World Wide Web Address • <http://www.Bare-Metal.com>

Hints and Tips:

Use our white decal film if your subject has white. This is because most copiers and printers do not print white.

For some subjects you may find it necessary to use both the white and the clear decal film. This is because when doing letters like "USAF" you do not want a white background behind these letters.

In some cases where the white is undesirable around your image, like a U.S. Air force insignia, print the insignia on the clear decal film. Then cut a piece of the white film to fit under the insignia. Apply the piece of white film and while still wet apply the red and blue over it. The white will show through where it needs to be and you didn't have to print the white.

Color Separations:

If you are copying a current decal to a larger or smaller scale with a color copier you may want to transfer the sheet onto a sheet of white styrene first. This is due to the blue background on the master decal. Following this procedure will prevent the color copier from printing the blue onto your new decal.

Photocopier Update:

The Bare-Metal Foil Co. has had this product tested on various commercial machines, such as the Canon 550 and Xerox Regal 5790, with great results. Further, we have had no reports of any damage or jamming of machines from users around the world.

Note:

You will achieve best results when the decal is put through the bypass tray. This will reduce the number of rollers the material has to travel through.

Inkjet:

This paper is for **INKJET PRINTERS ONLY**. Do not use this paper in laser printers or color copiers.

Inkjet printers use liquid inks to create images on paper. Making DECALS with this type of printer requires decal paper with a special coating which prevents the liquid inks from beading.

Be aware that some printers do not print the colors opaque enough. This is the fault of the printer, not the paper. For instance, the color may look good on the paper but when applied over a dark colored model the color will change. This is especially true with yellow. If this occurs you can try a heavier setting on your printer. If this does not work you may try a second printing of the same image and place it over the first. Another option is to print your subject on the white laser decal paper so it will have an undercoat.

If you are going to print a photo as a decal you should print it on the white laser decal paper to pick up any white in the photo.

After printing your decal be sure to clear coat it as in **Step #2**.